



Morgans

PROPERTY

22 East Whitefield, Dunfermline, KY12 0RH

Offers Over £270,000





Two-bedroom detached bungalow



Shower room



Large living room



Single garage



Generous fitted kitchen



All accommodation on one level



EPC Rating -



Council Tax Band -





## Welcome

This two-bedroom detached bungalow offers well-proportioned single-storey accommodation, suitable for a range of buyers including those seeking the convenience of level living. The accommodation comprises a generous living room, modern dining kitchen, two good double bedrooms with fitted wardrobes and a shower room. The rooms are comfortably proportioned throughout, with the living room in particular offering a notably spacious reception area. The property also benefits from a detached single garage, providing secure parking or additional storage space and well maintained gardens to the front and rear. Situated at East Whitefield, Dunfermline the property is within easy reach of local amenities, schools, and transport links.





### **EXTRAS INC. IN SALE/AGENTS NOTE**

All floorcoverings, blinds, bathroom and light fittings together with integrated appliances.

From 1st February 2022, residential properties in Scotland are required by law to have installed a system of inter-linked smoke alarms, carbon monoxide detectors and heat detectors (the "inter-linked system"). No warranty is given that any interlinked system has been installed in this property and interested parties should make their own enquiries.





## Dunfermline

The ancient capital of Dunfermline won its bid to have official status city in May 2022, as part of the civic honour's competition to celebrate the Queen's platinum jubilee. The City of Dunfermline is of considerable historic interest and is the resting place of King Robert the Bruce. Carnegie's Birthplace museum, the Abbey and Abbot House reflect the historic interest of the city, whilst recent developments have seen Dunfermline move into the modern era with Carnegie Museum and Library. Dunfermline is located approximately five miles from the Forth bridges and is therefore particularly popular with commuters to Edinburgh and many parts of the central belt with easy access to the M90 motorway with its direct links to Edinburgh, Perth and Dundee and across the Kincardine Bridge by way of motorways to Stirling, Glasgow and the West. It benefits from a full range of shops, social and leisure facilities and educational establishments. The local railway stations provide a regular service to Edinburgh with intercity links to other parts of the UK. There are regular and convenient bus services both local and national.

## Morgans Property Package

We provide the complete buying and selling package including a comprehensive estate agency service and full legal service. For a FREE PRE-SALE VALUATION, estimate and market appraisal without cost or obligation, contact us.



East Whitefield, Dunfermline, KY12 0RH

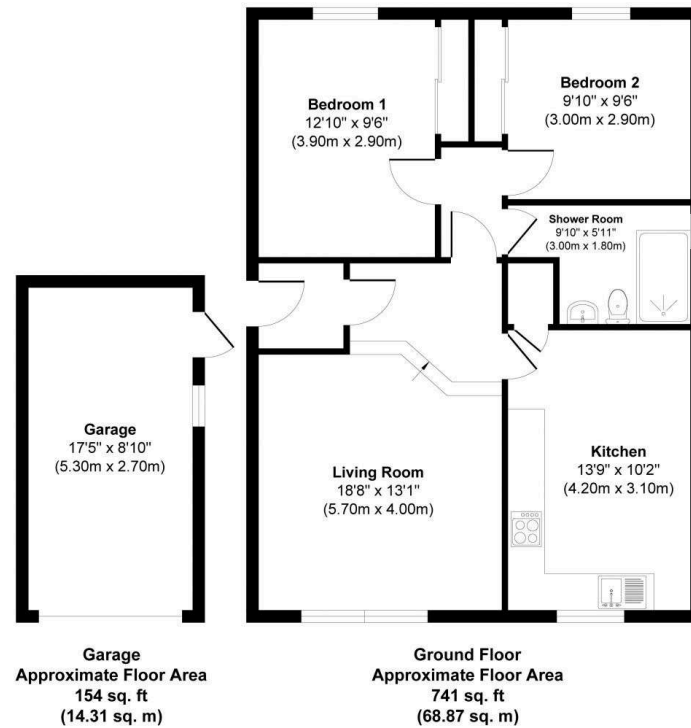

Approx. Gross Internal Floor Area 895 sq. ft / 83.18 sq. m

Illustration for identification purposes only, measurements approximate, not to scale. Copyright



SOLICITORS | PROPERTY  
33 East Port, Dunfermline, Fife, KY12 7JE  
Tel: 01383 620222 Fax: 01383 621213  
[www.morganlaw.co.uk](http://www.morganlaw.co.uk)



AGENTS NOTE These particulars do not form part of any contract and the statements or plans contained herein are not warranted nor to scale. Approximate measurements have been taken by electronic device at the widest point. Services and appliances have not been tested for efficiency or safety and no warranty is given as to their compliance with any Regulations. No movable items will be included in the sale.